



**AW MILLER**  
TECHNICAL SALES, INC.

EAST AURORA, NY  
716.652.8282

HARMONY, PA  
724.453.1690

STE-LAURENT, QC  
514.333.9174

HARLEYSVILLE, PA  
215.256.8281

# VC-EZ

SERIES

**Mazak**



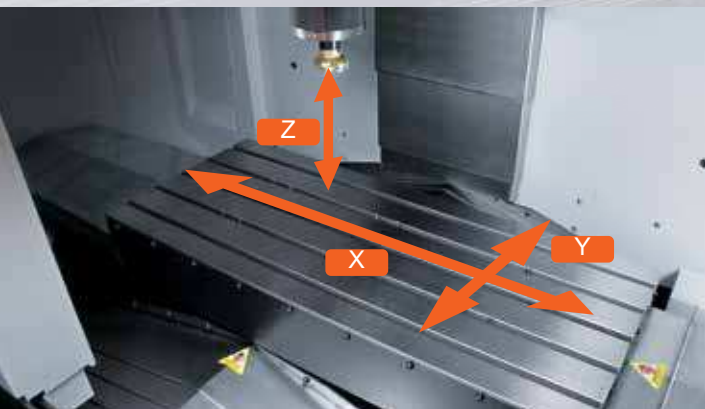

### Sample Workpieces

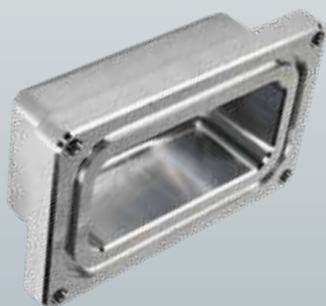
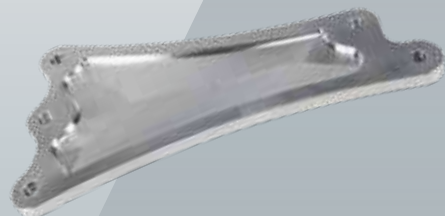
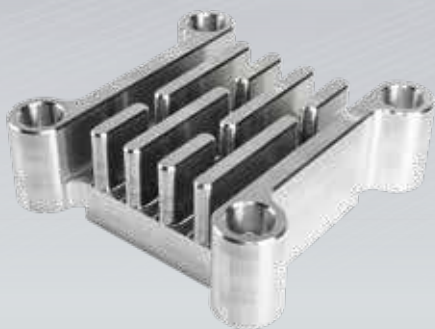

## Affordability and Performance

Expanding the Mazak legacy of dependable, high-quality vertical machining centers, the VC-Ez Series of machines delivers high performance and accuracy with unparalleled value. Designed and built in Kentucky, VC-Ez machines are optimized for simple operation as well as fast and easy installation, enhanced ergonomics, and stable and reliable part processing with long-term reliability.

*Hybrid MX Roller Guideway Systems on all linear axes*

*Pre-tensioned ballscrew system with support at each end*

*Thermal Shield technology ensures continuously stable machine accuracy*

*Compact designs that focus on ease of use and maintainability*



VC-Ez 20 with MAZATROL SmoothEz

# VC-EZ SERIES

# High-Productivity Vertical Machining Centers



VC-Ez 16  
CAT 40



VC-Ez 20  
CAT 40

●:Standard ○:Option

	VC Ez 26	VC Ez 32	VC Ez 32 CAT50
Table size	55.12" X 24.02"	64.17" X 28.35"	64.17" X 28.35"
Rapid rates X, Y, Z axis	1,417 ipm	1,259 ipm	1,259 ipm
Tool magazine (standard/optional)	30 / 50	30 / 50	24 / 40
6,000 min <sup>-1</sup>	-	-	●
12,000 min <sup>-1</sup>	●	●	-
15,000 min <sup>-1</sup>	○	○	-



VC-Ez 26  
CAT 40



●:Standard ○:Option

Model	rpm	
	12,000 min <sup>-1</sup>	15,000 min <sup>-1</sup>
VC-Ez 16	●	○
VC-Ez 20	●	○
VC-Ez 20 2PC	●	○

Model	Table size	Rapid rates X, Y, Z axis	Tool magazine (standard/optional)
VC-Ez 16	37.40" X 14.17"	1,417 ipm	30 / 50
VC-Ez 20	49.21" X 19.37"	1,654 ipm	30 / 50
VC-Ez 20 2PC	39.37" X 19.69"	1,260 ipm	30 / 50

VC-Ez 20 2PC  
CAT 40



VC-Ez 32  
CAT 40 / 50

# High Productivity

Precision, accuracy and rigidity by design

## Spindles

- Precision-balanced spindle cartridges
- Thermally controlled spindle minimizes growth and contraction for stable machining
- Large headstock castings eliminate torsional displacement when heavy side-load milling

## Structure

- Heavy base, column, saddle and headstock castings are all designed with high-speed and high-torque cutting applications in mind
- Castings and ambient thermal conditions are monitored to make axis adjustments for part-to-part consistency

## MX Roller Guide System

- More surface contact for greater load capacities
- Higher positioning accuracy than boxways
- Faster and greener than boxways, with nearly twice the rapid traverse rate and less contamination in machine coolant system

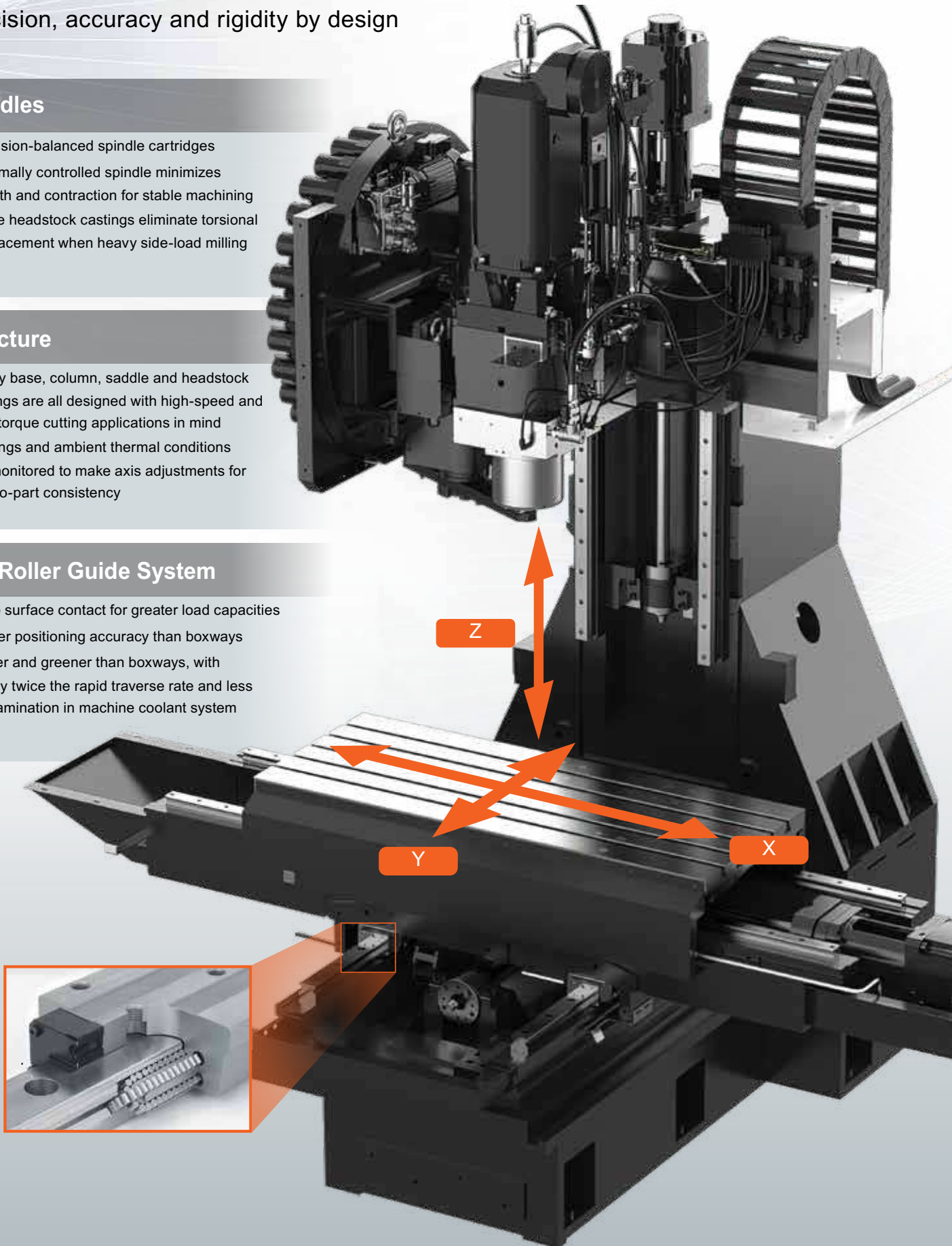



# Thermal Displacement Control

In addition to environmental changes such as increases or decreases in room temperature, operations such as spindle start/stop create sudden expansions and contractions in the spindle. Being able to monitor and react to thermal disruption provides stable machining accuracy that can be maintained over long periods of time.



▶ Example of compensation with Thermal Shield

Spindle speed acceleration test  
(68°F/20°C constant temp.)

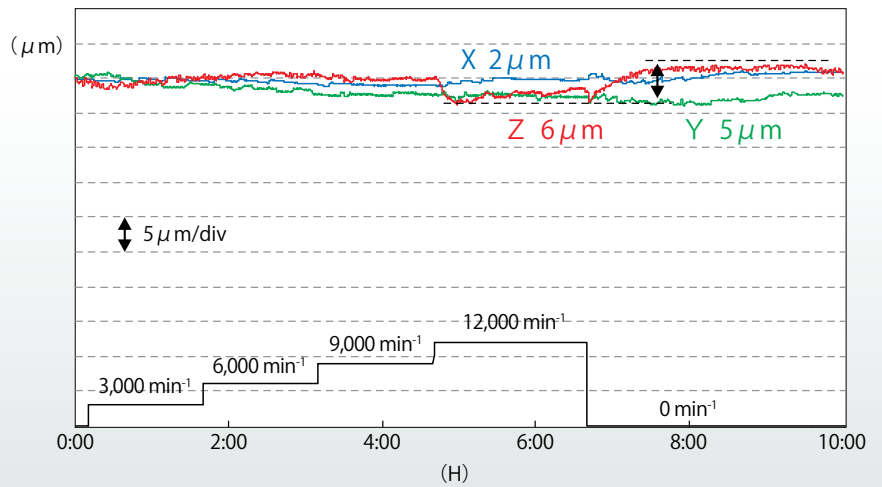

Environmental change test  
(45°F/7.2°C change)

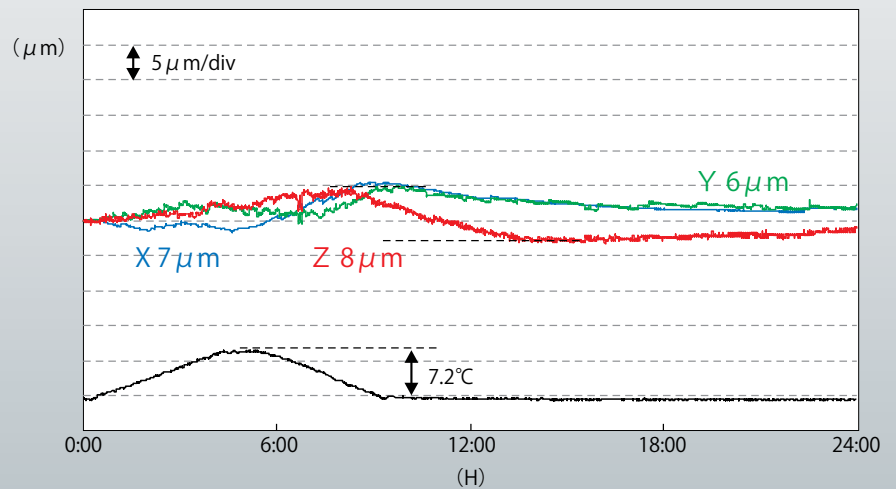

# High-Performance Spindles

High-speed cutting for greater productivity with CAT 40 spindles

**Spindle output: 25 hp/18.5 kw (standard)**

CAT 40, 12,000 min<sup>-1</sup>

This spindle gives shops the performance they need to achieve high productivity and exceptional accuracy. The standard VC-Ez series spindle delivers unbeatable metal removal rates for most common materials, including steel, aluminum and cast iron. The VC-Ez Series spindles employ the latest technology for the shortest possible acceleration/deceleration times. This air-cooled spindle uses grease-packed lubrication to reduce maintenance and oil consumption.

Power/torque chart

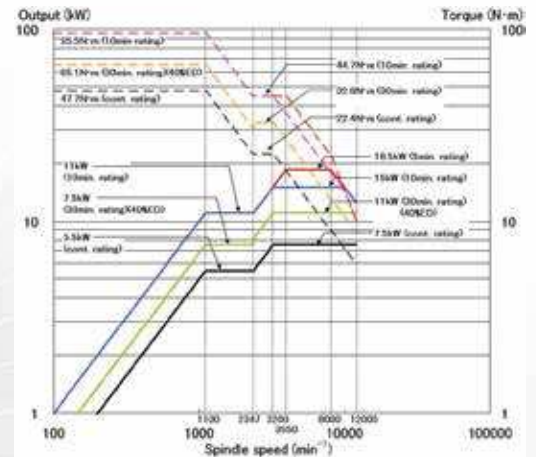

**Spindle output: 29.5 hp/22 kw (optional)**

CAT 40, 15,000 min<sup>-1</sup>

The optional 15,000 min<sup>-1</sup> spindle has an air-oil mist lubrication system design. This design is ideal for mass production and long run, short cycle parts. Designed to give you added flexibility for numerous applications and materials.

Power/torque chart

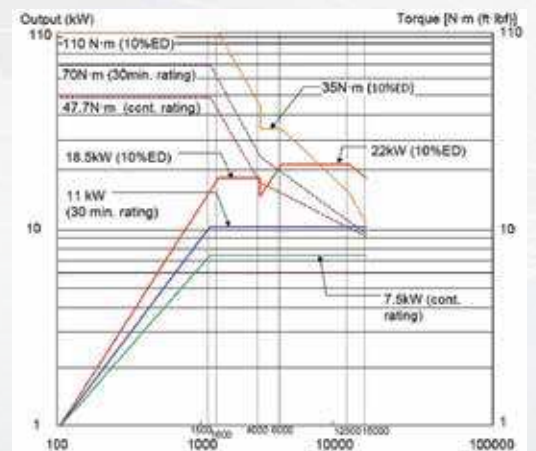

Rigid, aggressive cutting for greater productivity with the CAT 50 spindle

**Spindle output: 29.5 hp/22 kw (standard)**

CAT 50, 6,000 min<sup>-1</sup>

The 6,000 min<sup>-1</sup> spindle has an air-oil mist lubrication system design. This spindle uses an automatic two-speed gear box to maximize torque for aggressive cutting in difficult-to-machine materials.

Power/torque chart



# Features For High Productivity



## High-Speed ATC



Our high-speed ATC system utilizes a reliable servo-driven cam actuation system that aids in rapid tool change and reducing noncut cycle time. Spindle utilization is also increased through bidirectional rotation of the magazine to the next required tool position, adding productivity to your facility.

Standard tool changer time

**Tool to tool – 2.3 seconds**



## Tool Magazines



CAT50 40 tool ATC

High-capacity tool magazines minimize setup times and add capacity for redundant tooling.

Magazine capacities

CAT40 30 tool (STD) / 50 tool (OPT)

CAT50 24 tool (STD) / 40 tool (OPT)



CAT40 30 tool ATC

Specifications	VC-Ez 16	VC-Ez 20	VC-Ez 26	VC-Ez 32	VC-Ez 32 CAT50
Maximum tool length	13.78"/350 mm				
Maximum tool diameter	2.95"/75 mm			4.13"/105 mm	
Maximum tool diameter with adjacent pockets empty	30 tool ATC 5.91"/150mm			24 tool ATC 8.27"/210 mm	
	50 tool ATC 5.0"/127mm			40 tool ATC 8.27"/210 mm	

Maximum tool weight of CAT40 - 8kg (17.64 lbs)

Maximum tool weight of CAT50 - 15kg (33.07 lbs)

# Features For High Productivity



## Machine Work Envelope

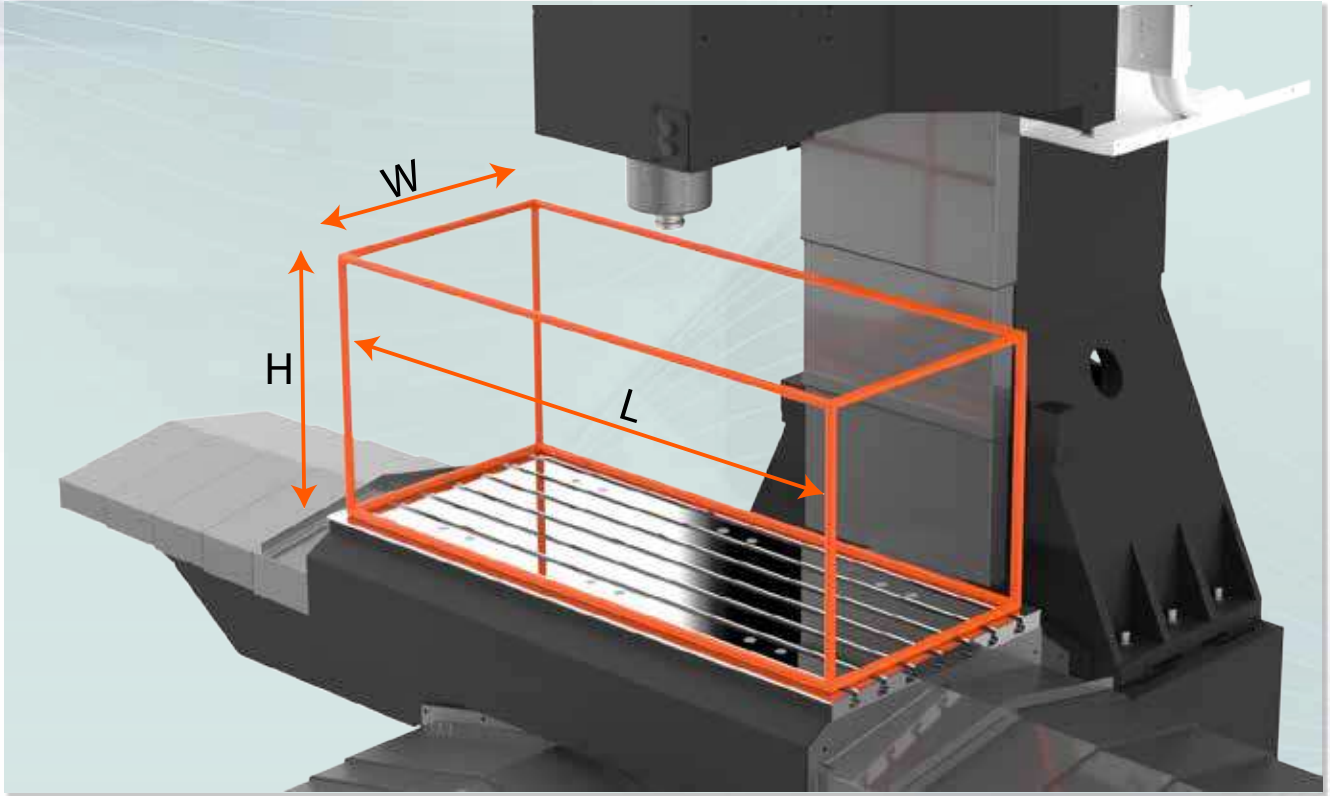

### Machine travel specification

	X-AXIS STROKE	Y-AXIS STROKE	Z-AXIS STROKE
VC-Ez 16	30" (762 mm)	16.14" (410 mm)	20.08" (510 mm)
VC-Ez 20	41.34" (1050 mm)	20.08" (510 mm)	25" (635 mm)
VC-Ez 26	50" (1270 mm)	25.98" (660 mm)	25" (635 mm)
VC-Ez 32	64.17" (1630 mm)	32.08" (815 mm)	30.12" (765 mm)
VC-Ez32 CAT50	64.17" (1630 mm)	32.08" (815 mm)	27.56" (700 mm)

### Maximum workpiece specification

	MAX. LENGTH (L)	MAX. WIDTH (W)	MAX. HEIGHT (H)	MAX. MASS
VC-Ez 16	37.4" (950 mm)	14.17" (360 mm)	17.72" (450 mm)	1543 lbs (700 kgs)
VC-Ez 20	49.21" (1250 mm)	19.37" (492 mm)	22.44" (570 mm)	2204 lbs (1000 kgs)
VC-Ez 26	55.12" (1400 mm)	24.02" (610 mm)	22.44" (570 mm)	3306 lbs (1500 kgs)
VC-Ez 32	64.17" (1630 mm)	28.35" (720 mm)	27.56" (700 mm)	4078.5 lbs (1850 kgs)

# Features for High Productivity



## Table Dimensions

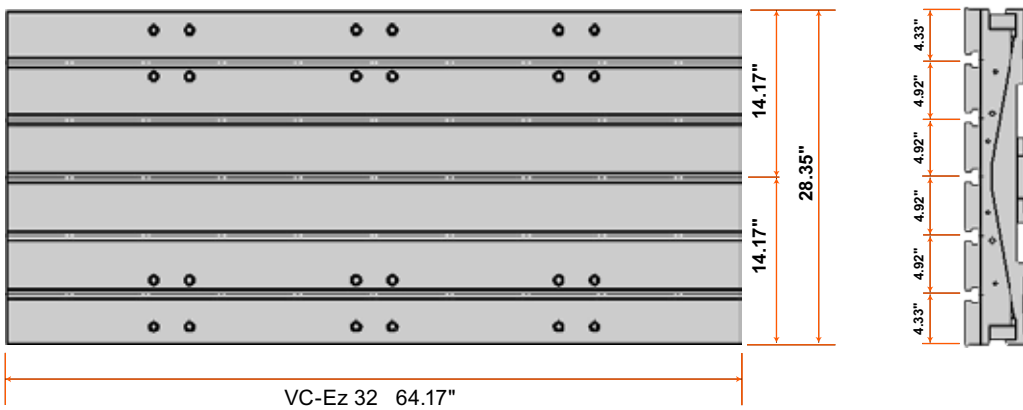
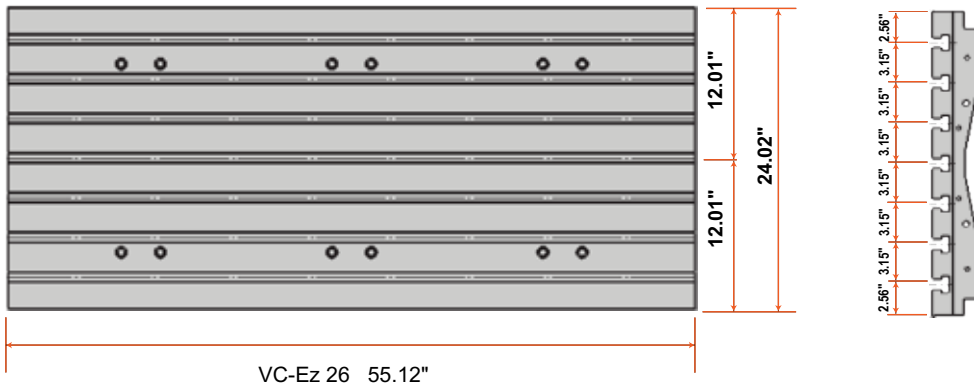
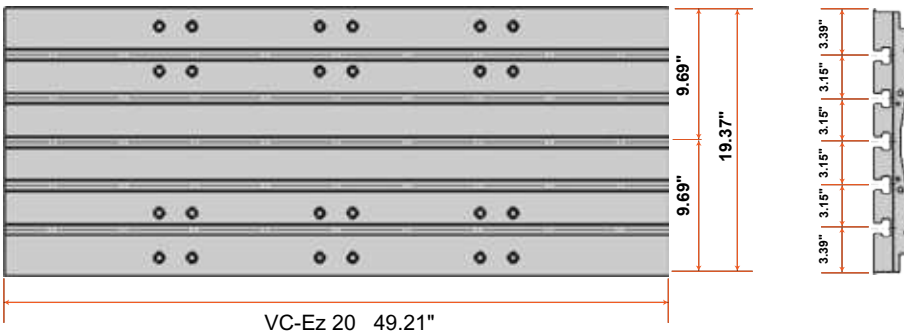
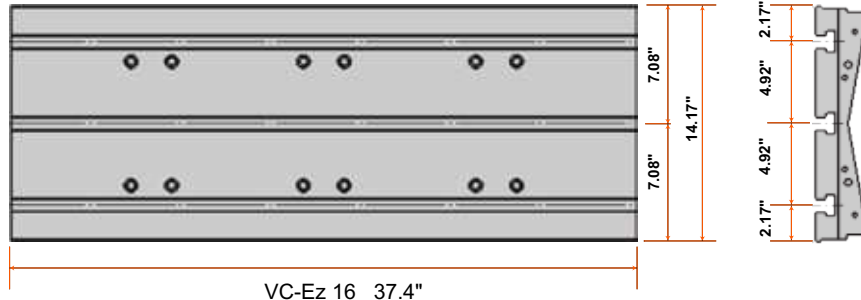

### T-Slot

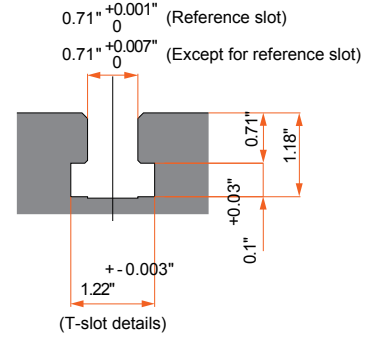

T-Slot measurement in inches

# Features For High Productivity



## Machine Work Envelope / Table Dimensions

VC-Ez 20 2PC



### Machine travel specification

	X-AXIS STROKE	Y-AXIS STROKE	Z-AXIS STROKE
VC-Ez 20 2PC	45.07" (1145 mm)	20.08" (510 mm)	20.08" (510 mm)

### Maximum workpiece specification

	MAX. LENGTH (L)	MAX. WIDTH (W)	MAX. HEIGHT (H)	MAX. MASS (per pallet)
VC-Ez 20 2PC	39.37" (1000 mm)	19.69" (500 mm)	20.08" (510 mm)	1322.77 lbs (600 kgs)

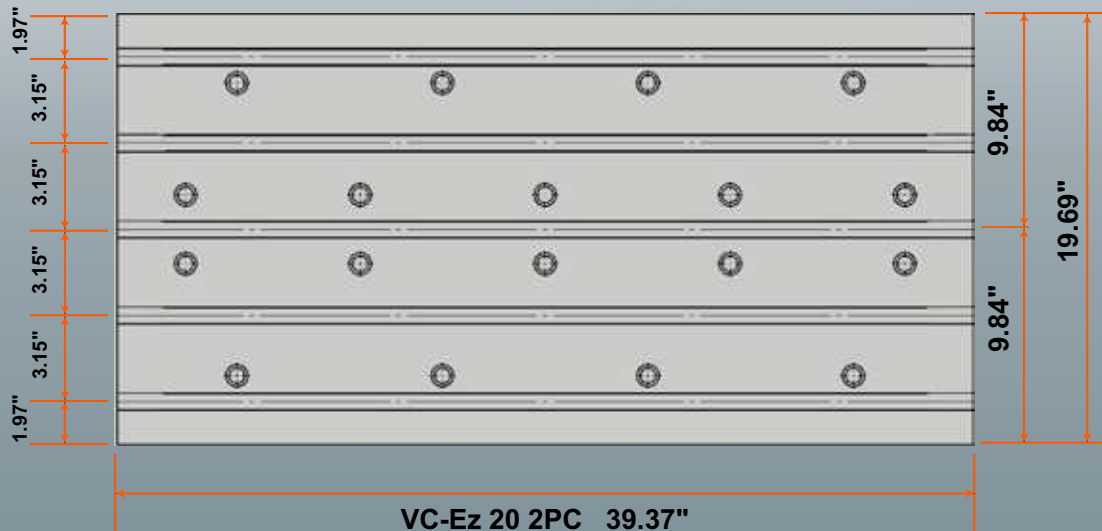

# Features for High Productivity



## Two Pallet Machine Overview – VC-Ez 20 2PC

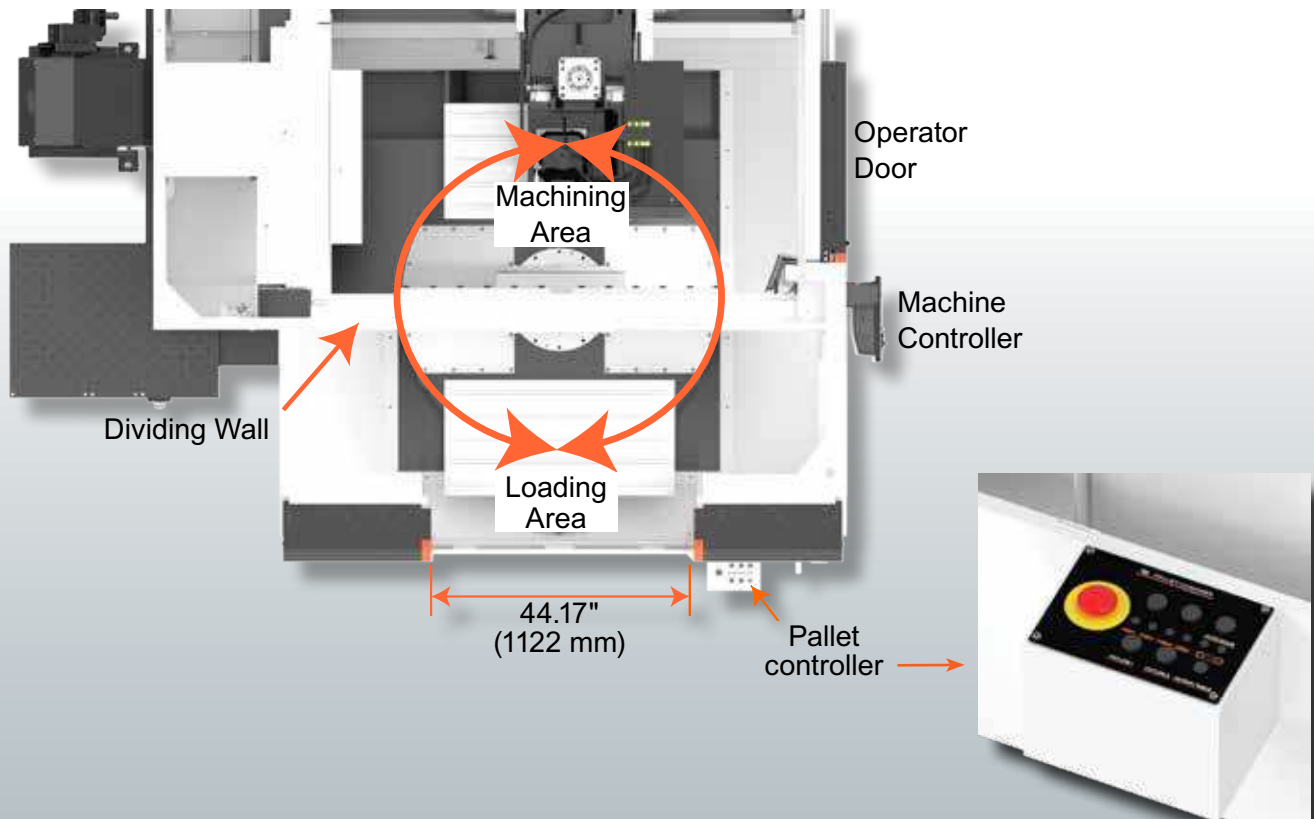

Mechanical locks are engaged after the pallet change is completed to prevent any movement of the pallets during machining and loading of parts.

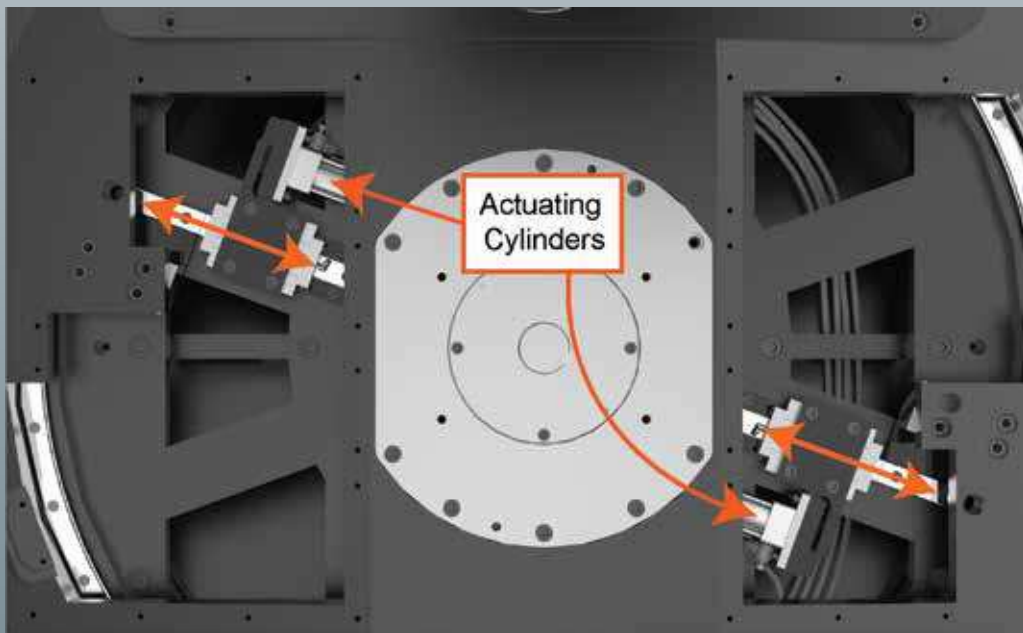

# Ease of Use

Ergonomic design emphasizes ease of operation and maintainability

## Part loading/unloading

Top door opening allows access to within 3.3" of table center for crane-loading of parts. Machine door opens wider than the table length for ample accessibility.



## 1 Wide door opening

VC-Ez 16: 37.40"    VC-Ez 20: 49.21"    VC-Ez 20 2PC: 44.17"    VC-Ez 26": 55.12"    VC-Ez 32: 66.93"



## 2 Ease of maintenance and safety

The centralized placement of commonly checked items facilitates and encourages daily maintenance.



## Easy tool loading/unloading

The tool clamp/unclamp switch is conveniently placed next to the spindle for ease of tool maintenance.



## 3 Table/spindle accessibility

New integrated chip collection system allows for a toe-kick on the entire front of the machine. VC-Ez Series machines have a floor-to-worktable height of only 41.10" and only 32.57" between the machine exterior and the spindle.



#### 4 Chip drawers

Models VC-Ez 16, VC-Ez 20 and VC-Ez 26 come standard with two chip removal drawers on the front of each machine. Operators can pull open these drawers to improve access for manual chip removal requirements. VC-Ez 32 comes standard with a chip auger.



#### 5 MAZATROL *SMOOTH EZ* Adjustable operator panel

MAZATROL SmoothEz CNC operation panel enhances usability. The swivel mount of the CNC control panel allows for rotation toward the work envelope for easy setup and operation.



\*Optional auger shown

#### 6 Removable covers

Covers are placed on both the left and right sides of the machines for easy chip removal and maintenance.

# Optional Accessories

## Ez Tool Station

VC-Ez Series machines incorporate Mazak's Ez Tool Station to store tools outside the machine, often eliminating the need for separate tool carts.



## NC Rotary Table

A fourth axis rotary table allows for processing multiple operations in one setup.



## Automatic Tool Length Measuring

A plunger-style tool-length measuring device.



## 4+1 NC Rotary Table

A four-plus-one axis rotary table allows for continuous 4th axis machining plus a fifth positioning axis, giving greater flexibility to machine parts complete in one setup.

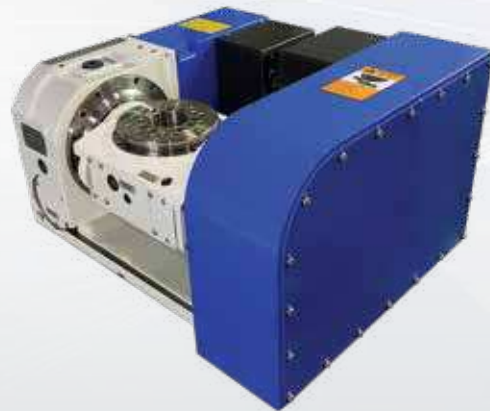

## Three-Color Status Light

Three colors to indicate the machine's current operating status. Green is normal operation. Yellow is a warning condition. Red is alarm, non-running condition.

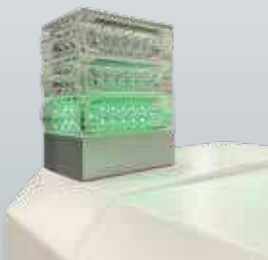

## Telescopic Air Nozzle

The air nozzle extends when air blast is actuated. The nozzle concentrates air to a desired position, optimizing chip evacuation while machining. (Programmable coolant sold separately)



## Workpiece Touch Probing

Contact-style touch probes decrease setup time while allowing operators to inspect workpieces before removal from the machine.



## Automatic Tool Setter

The addition of a contact tool setter can reduce set-ups by measuring both tool length and diameter. In-process measurements can also be accomplished for unattended part processing.



## Automation

### Custom Solutions

Mazak Automation Systems department can custom design a system that's right for your application. Additional options necessary to integrate automation on your new VC-Ez machine are also available.

- \* robot interface
- \* auto door
- \* electrical and mechanical fixture interface

Various other software options are also available to make sure that your custom system performs at the highest level.

### EZ LOADER

Easy installation and setup makes the EZ LOADER automation cell a great choice for shops looking for unattended operation. This factory-supplied solution ensures that the EZ LOADER and machine work together flawlessly from the start. The system comes with a vision sensor and templates for stock along with easy icon pattern timeline programming .



Ez Loader 30

# Optional Accessories



## NC Rotary solutions

### Dual NC Rotary tables

#### VC-Ez 20 2PC

The VC-Ez 20 2PC has a 2-pallet, non-lift mechanism that allows for an NC rotary table on each pallet. This allows for replacing a completed part while the unfinished part is being machined.

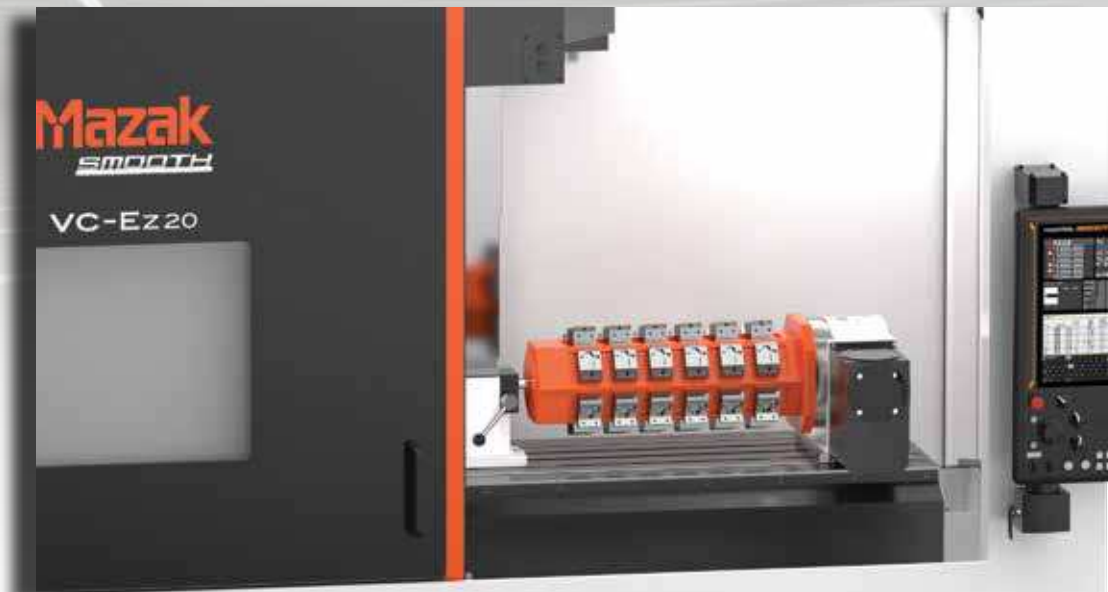
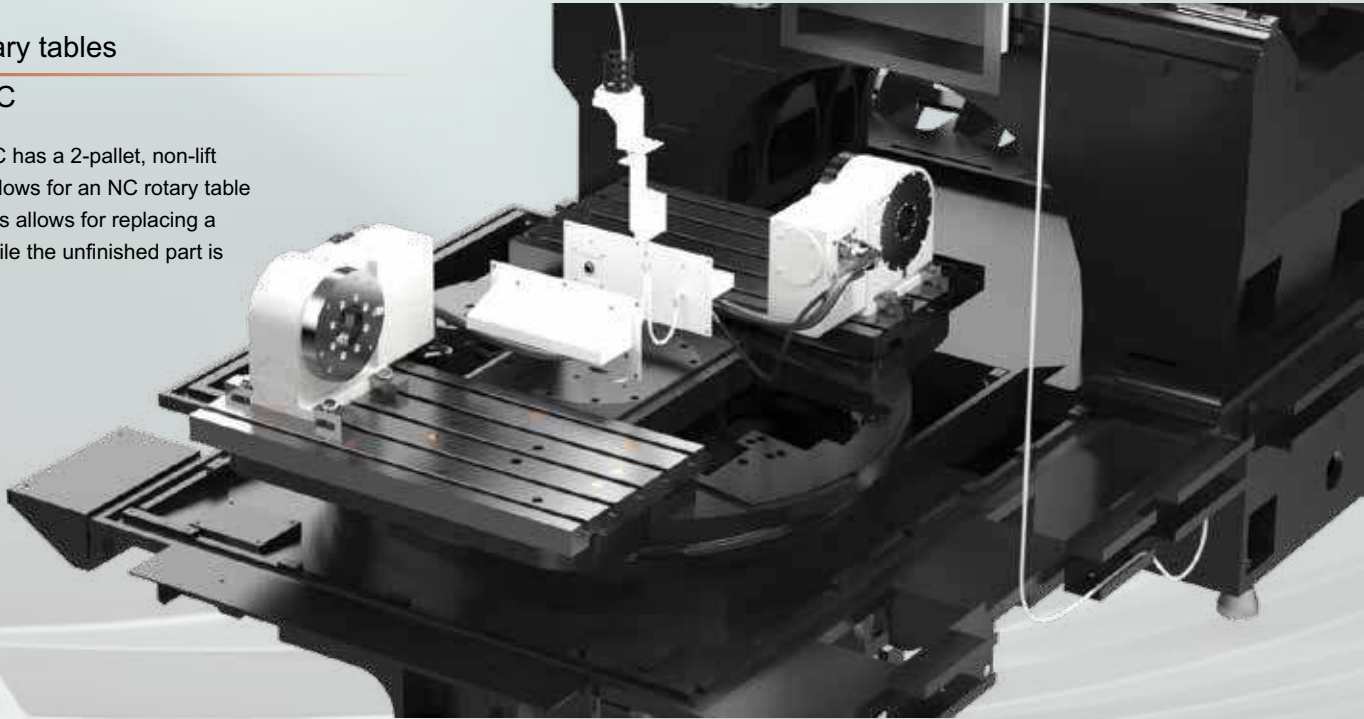

### NC Rotary Table solutions

#### VC-Ez 20

VC-Ez 20 with custom tombstone workholding mounted on a MR250 NC rotary table and supported by manual center.

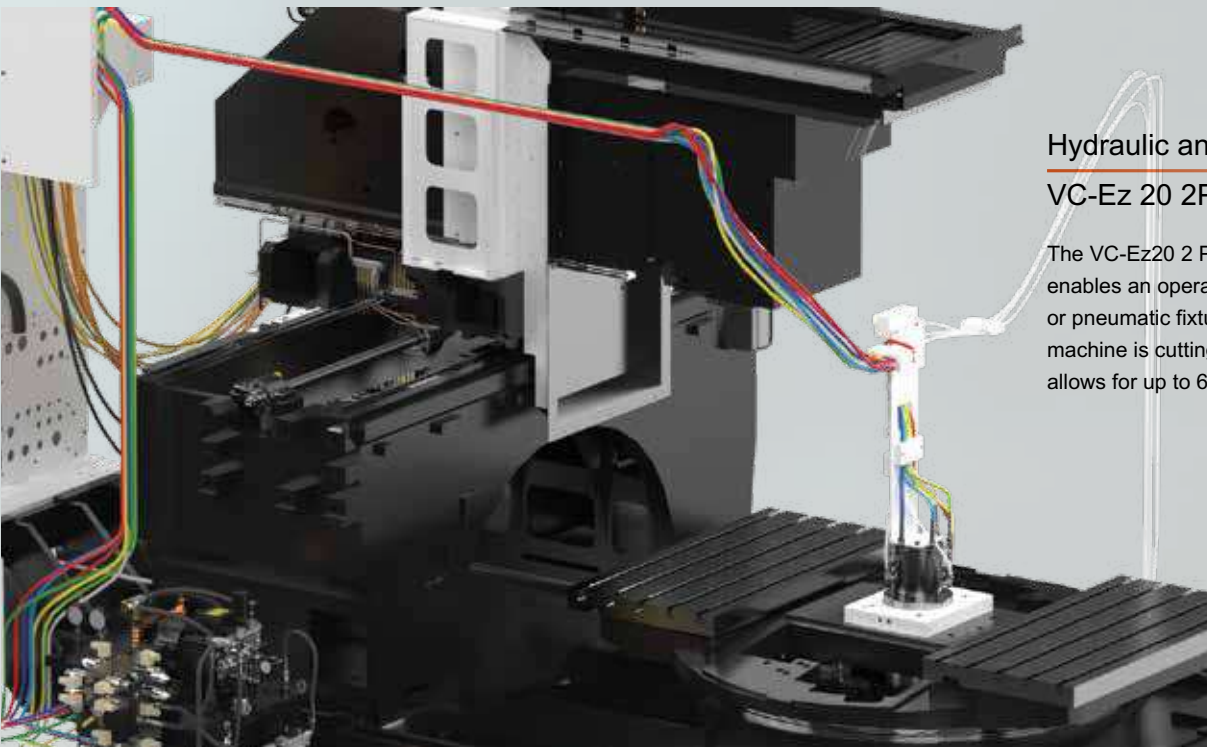

### Hydraulic and Pneumatic Fixture Prep VC-Ez 20 2PC

The VC-Ez20 2 PC has an optional fixture prep that enables an operator to service a part on a hydraulic or pneumatic fixture at the loading station while the machine is cutting on the other pallet. The option allows for up to 6 ports on each pallet.

### Single-Pallet Fixture Options

#### VC-Ez 20 2PC

- 3 Port (HYD: 2 port / Air: 1 port)  
(clamp/unclamp/seating detection)
- 4 Port (HYD: 2 port / Air: 2 port)  
(clamp/unclamp/seating detection/air blow)
- 6 Port (HYD: 4 port / Air: 2 port)  
(clamp x2/unclamp x2/seating detection/air blow)



### Double-Pallet Fixture Options

#### VC-Ez 20 2PC

- 3 Port (HYD: 2 port / Air: 1 port) / Pallet  
(clamp/unclamp/seating detection)
- 4 Port (HYD: 2 port / Air: 2 port) / Pallet  
(clamp/unclamp/seating detection/air blow)
- 6 Port (HYD: 4 port / Air: 2 port) / Pallet  
(clamp x2/unclamp x2/seating detection/air blow)

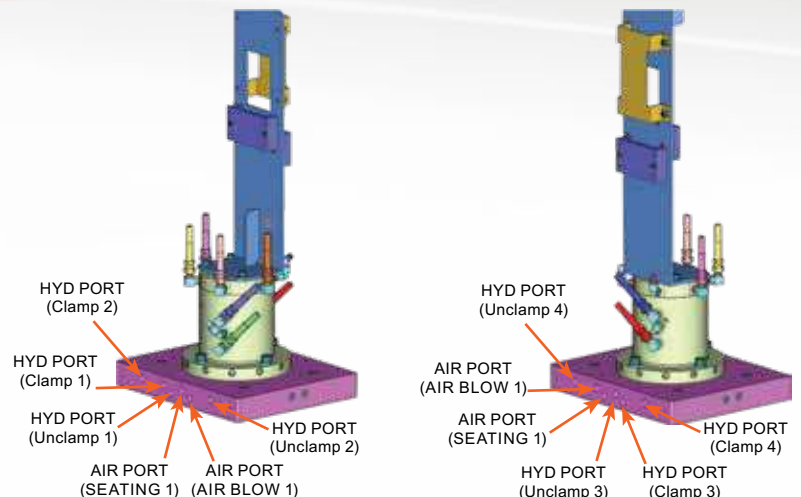

# Optional Accessories



## Coolant / Chip Removal Options

### Flood Coolant

Coolant flows from nozzles in the spindle face, helping to remove chips, reduce temperature and friction on the workpiece. Flood coolant of 100 psi is standard.



### Mazak SUPERFLOW 1,000 psi

Using high-pressure coolant and ported tooling boosts productivity while maximizing tool life. Three main factors drive the productivity of increased tool life, repeatable tool wear and cutting condition maximization.

### Programmable Coolant

Programmable coolant nozzles are adjusted from outside the machine to direct the coolant stream to a desired position to optimize chip evacuation while machining.



### Through-Spindle Coolant

Through-spindle coolant along with ported tooling gives a concentrated flow of coolant for added chip removal, heat dissipation and lubrication. Pressure is offered in three options: 71 psi, 213 psi or 1,000 psi.



### Through-Spindle Air Blast

Shop air is funneled through the spindle taper for use with ported tooling. Air pressure at the cutting edge displaces previously cut chips, dramatically improves tool life and surface finish for dry cutting applications.

### Cover Coolant Including Handheld Coolant Nozzle

Cover coolant disperses cutting chips that accumulate from material removal. Efficient removal of cutting chips extend maintenance periods. This option comes standard with 71 psi and is upgradeable to 213 psi. The included handheld coolant nozzle is ideal for cleaning chips from workpieces and the entire interior of the machine.



## Mist Collector

Reclaiming the mist generated in VC-Ez Series machines is critical to maintain a healthy and productive machining environment for operators. Systems are sized to each specific model to ensure proper operation. Direct machine mount or free-standing pedestal designs are offered.



## Easy Tool Magazine Access

VC-Ez 16, 20, and 26 models offer an optional magazine access door to load and unload tools outside the cutting area. The VC-Ez 32 is equipped with stairs and handrails to provide safe and easy access to the standard tool magazine access door.



## Spiral Auger Conveyor

This chip management solution eliminates the need for manual chip removal from the machine. This option is ideal for long chipping material (standard on VC-Ez 32).



## Chip Conveyor (Hinge Type)

Further reduces chip-related maintenance interruptions and is ideal for evacuating higher-volume curled iron-based chips.



# MAZATROL SmoothEz Control

An intuitive, 15" capacitive touchscreen HMI coupled with a dual-core, 800MHz processor combines unparalleled power with ease of use.

MAZATROL  
**SMOOTHÉZ**



## Five informative process home screens

The process home screens were developed to place commonly used functions required for machine operation and maintenance in one convenient location.

Launcher



MAZATROL

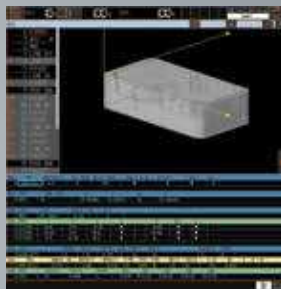

DATAGUARD



Thermal Comp



Maintenance



## MAZATROL *SMOOTH EZ*

### High-performance chip-conveyor interface

Our GUI interface gives operators control of their chip-management solution. Reducing coolant loss and downtime due to chip-related issues creates higher productivity and decreased maintenance.



# Programming

## MAZATROL Interactive programming

MAZATROL interactive programming uses common language, so you can easily create and edit programs simply by entering data from a part drawing. Inexperienced operators can quickly learn to create programs by utilizing preset cutting conditions and automatic tool path creation.



### QUICK MAZATROL

Patent pending

MAZATROL  
**SMOOTHEZ**

### Interactive programming reduces time

QUICK MAZATROL offers the programmer/operator the option to see – in real time – a 3D model of the finished workpiece as they create the program. This reduces errors that are usually not found until the actual machining has occurred. Once the program has been created, one can easily modify features on the workpiece by simply touching the desired MAZATROL unit and making the edits.

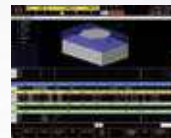

Touching a feature in the UNIT LISTING will highlight the feature in the 3D model and instantaneously take you to the corresponding MAZATROL machining unit in the program. Once there, you can edit the machining unit or navigate freely.

Displays a real-time 3D model of the processed workpiece based on the program.

### SMOOTH CAM AI

Option

SMOOTH  
CAM AI

Used for off-line programming and simulation of both EIA/ISO and MAZATROL programs.

- Tool path check (VIEW SURF)
- Interference check, time study (virtual machining)
- SOLID MAZATROL
- DIGITAL TWINS capable



## Intelligent Pocket Milling

Intelligent Pocket Milling is a MAZATROL pocket machining cycle, which calculates a constant contact angle between the tool edge and the workpiece material. This Intelligent path controls spindle and axis fluctuations, extending tool life and improving machining efficiency especially in hard-to-machine materials.

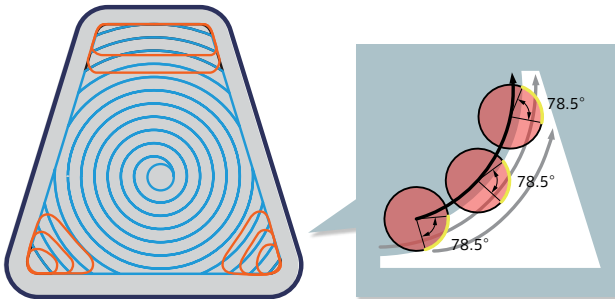

## Line Machining

Previous MAZATROL programs for line machining required the programmer to create multiple units to allow for radial step-over to create the required shape. Our SmoothG control is able to accomplish this in one unit with easy program inputs.

Conventional program screen

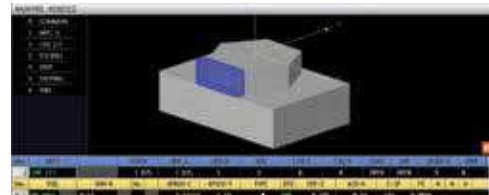

## VFC Function

While running a MAZATROL program and changing the speed and/or feed overrides during an operation the operator can press the VFC key and the control then learns the altered cutting conditions and writes those to the current MAZATROL program.



## MAZAK MT Tablet

Option MAZATROL  
**SMOOTH-EZ**

The optional MT Tablet provides a 10" HD display. This Windows 10 IoT-based interface allows access to various productivity apps.

- MTConnect®
- MAZAK SMOOTH LINK
- MAZAK Manual Viewer
- MAZAK Program Transfer

MT TABLET packages contain a one-year subscription to one of three popular CAM software packages.



# External Dimensions – VC-Ez 16, 20 & 20-2PC

(FOR REFERENCE ONLY)

## VC-Ez 16

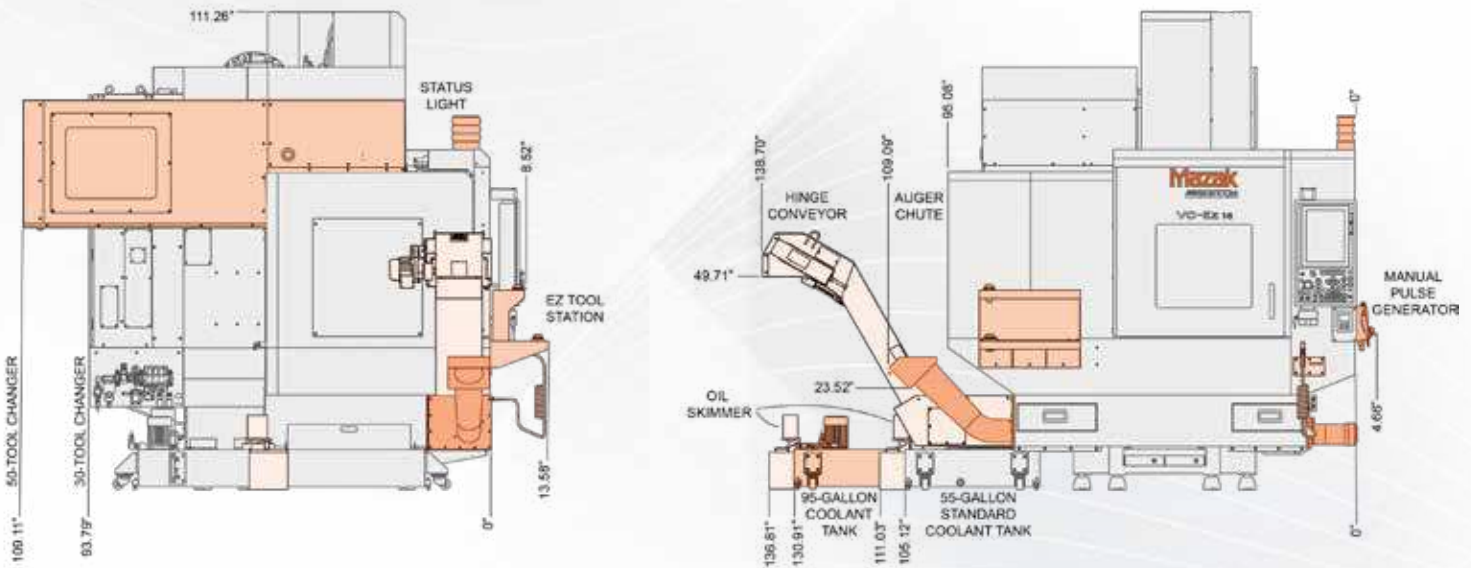

## VC-Ez 20

Orange-shaded areas represent optional equipment

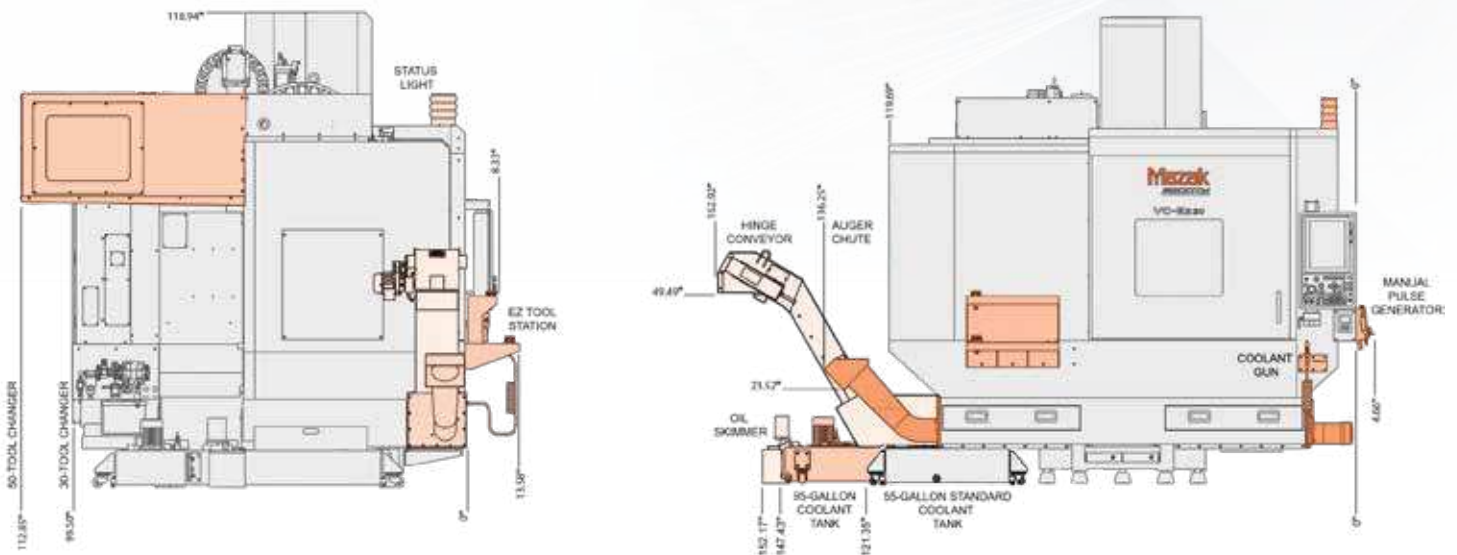

# VC-Ez 20 2PC

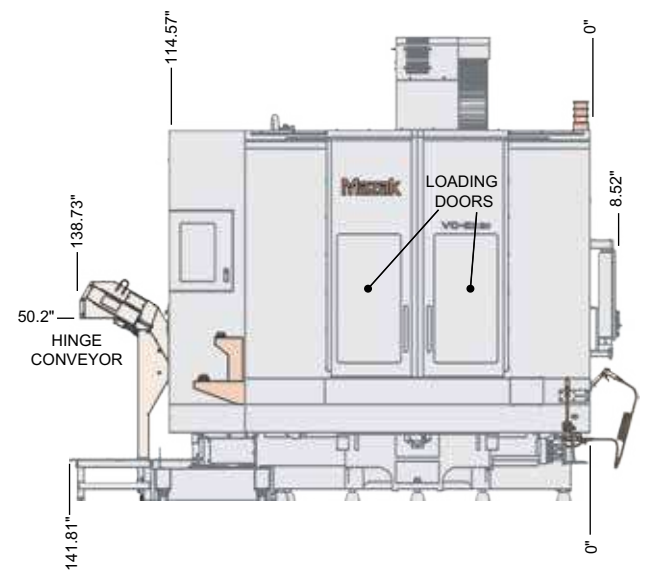
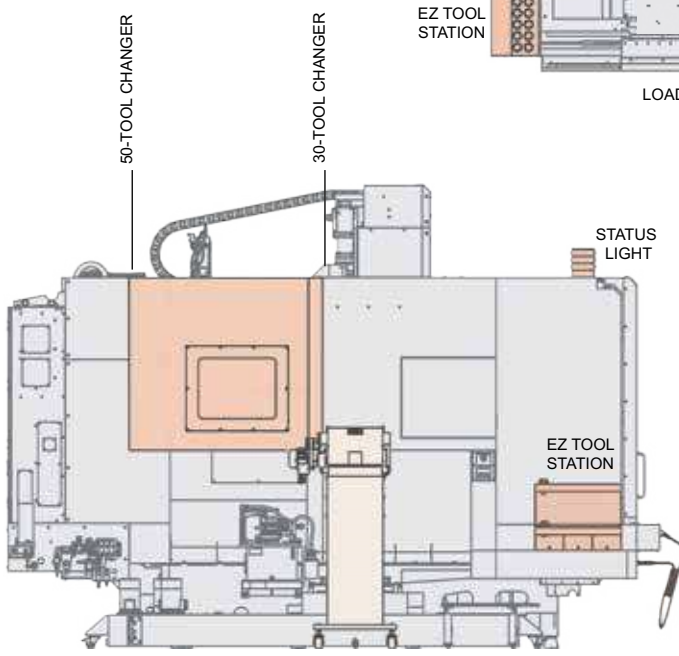
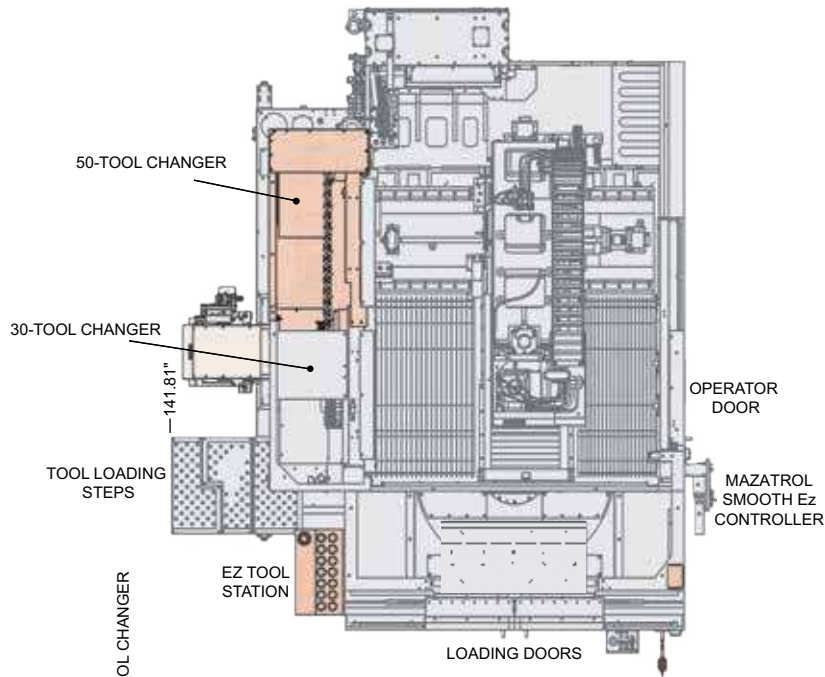

90-GALLON STANDARD COOLANT TANK

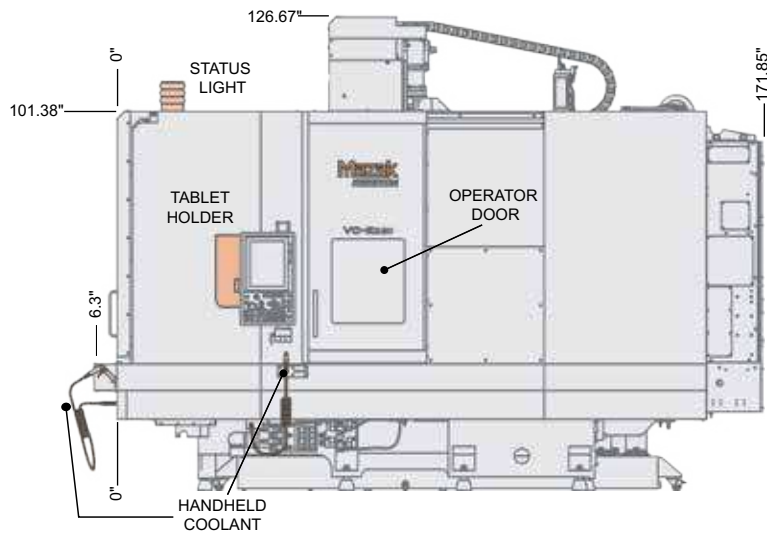

# External Dimensions – VC-Ez 26 & 32

(FOR REFERENCE ONLY)

## VC-Ez 26

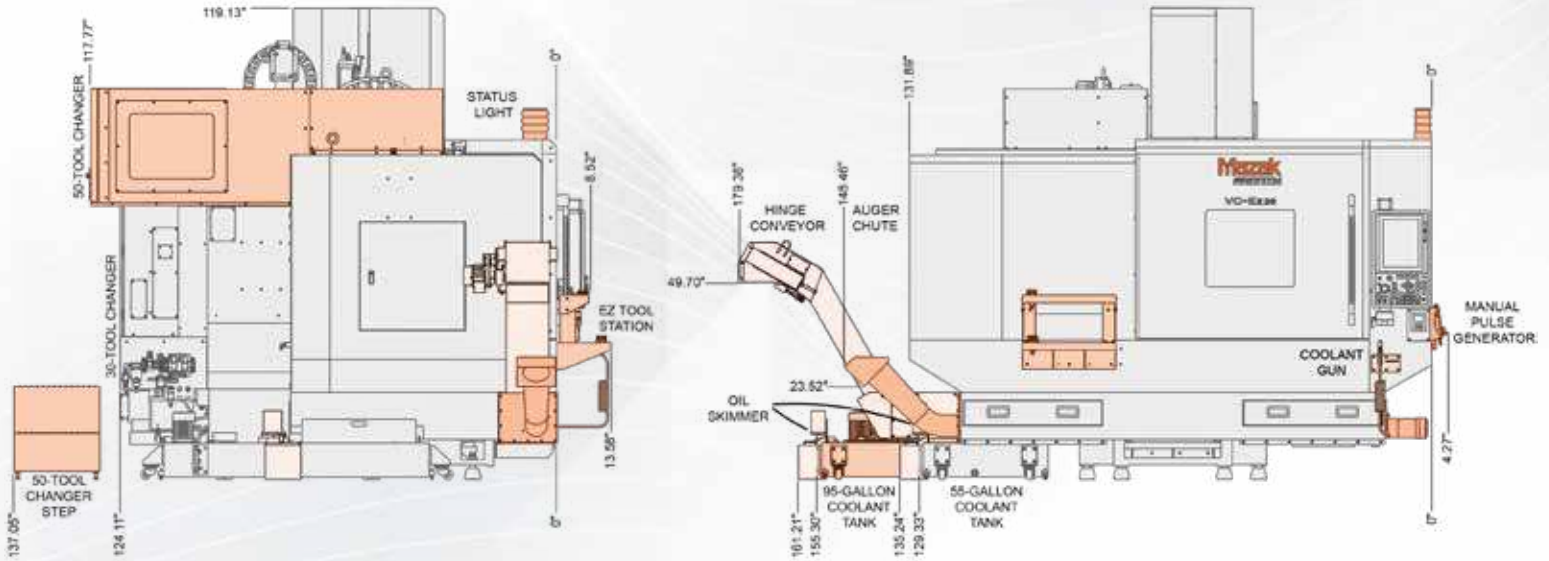

## VC-Ez 32

Orange-shaded areas represent optional equipment

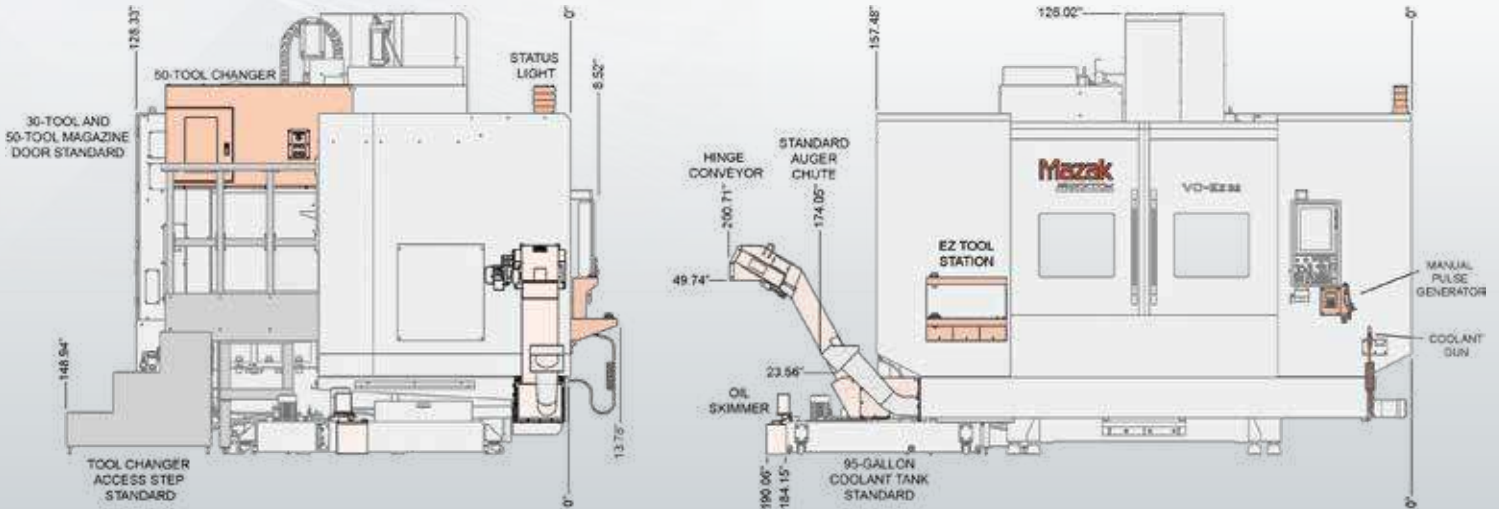

# VC-Ez 32 #50

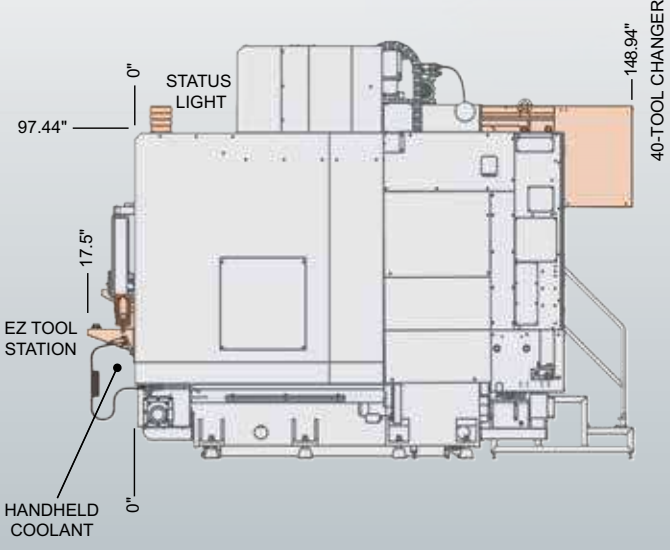
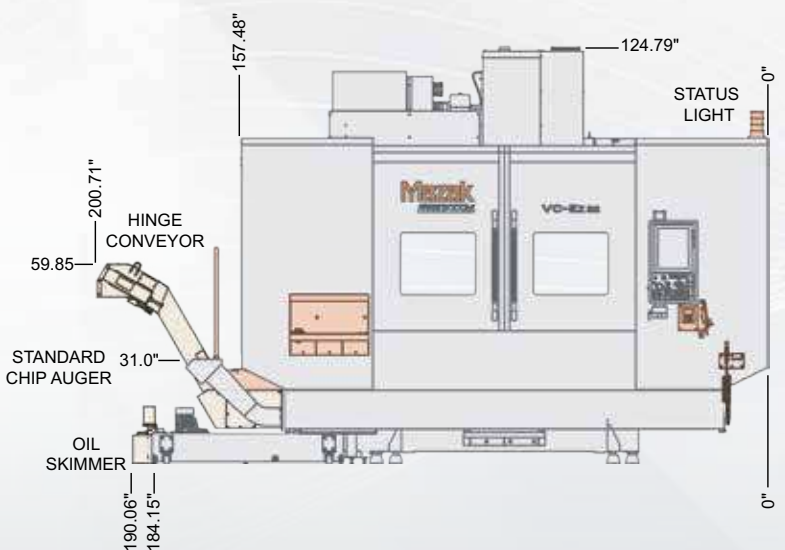
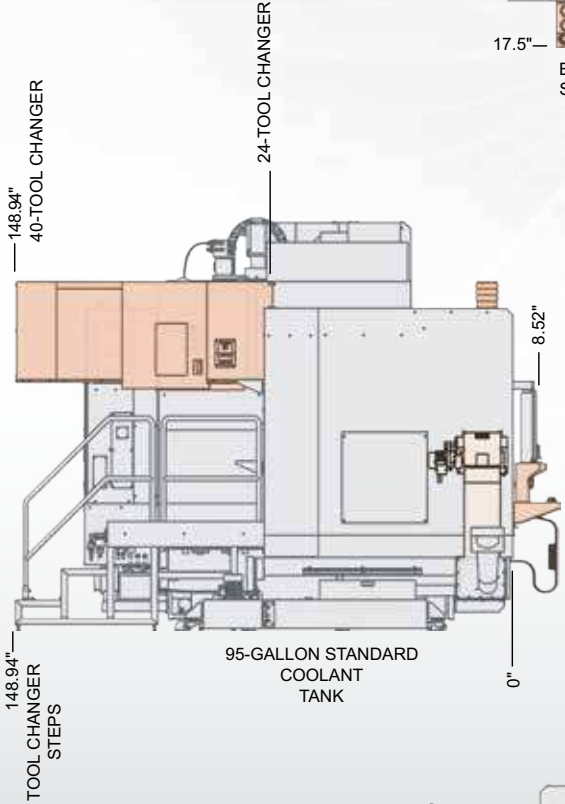
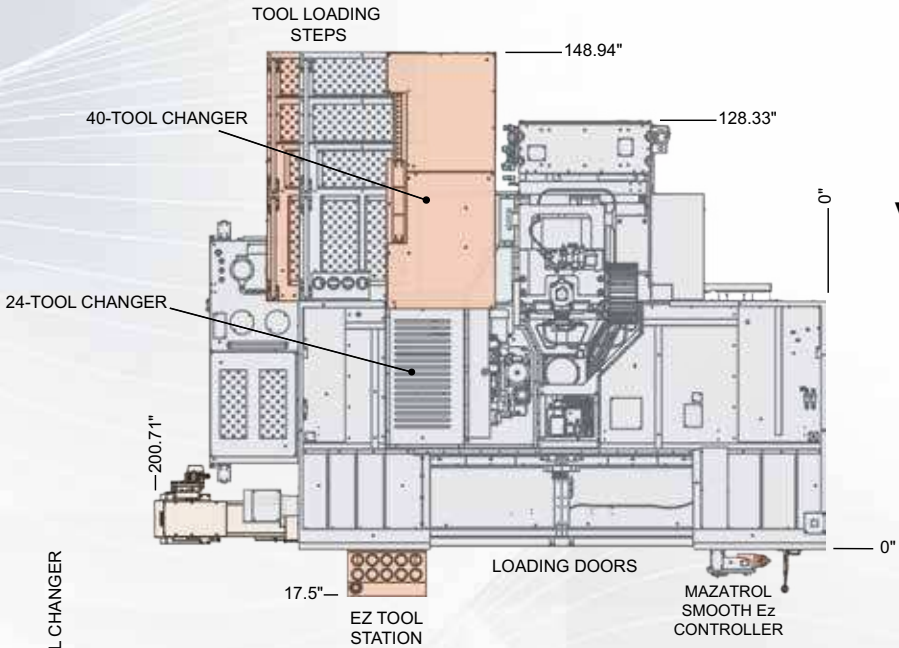

Orange-shaded areas represent optional equipment

# Machine Specifications – VC-Ez

Capacity	Table Width	in (mm)
	Table Depth	in (mm)
Table Weight Capacity	Table Weight Capacity	lbs (kg)
Spindle Face to Table	Min - Max	in (mm)
Rapid Rates	Rapid Rates	ipm
Spindle	Spindle Taper	
	Maximum Speed	rpm
	Maximum Speed (Optional Spindle)	rpm
	Motor Output	hp (kw) (5-minute rating)
	Motor Output (Optional Spindle)	hp (kw) (10% ED)
	Torque	ft-lbs (N-m)
	Torque (Optional Spindle)	ft-lbs (N-m)
Magazine	Number of Tools	Standard (Optional)
Feed Axes	Travel (X Axis)	in (mm)
	Travel (Y Axis)	in (mm)
	Travel (Z Axis)	in (mm)
Maximum Tool Diameter	Without Adjacent Pockets Empty	in (mm)
	With Adjacent Pockets Empty	in (mm)
Maximum Tool Length		in (mm)
Maximum Tool Weight		lbs (kg)
Tool Change Time	Tool to Tool	sec
Dimensions	Machine Depth	in (mm)
	Machine Width	in (mm)
	Machine Height	in (mm)
	Machine Weight	lbs (kg)

VC-Ez 16	VC-Ez 20	VC-Ez 20 2PC
37.40 (950)	49.21 (1,250)	39.37 (1,000)
14.17 (360)	19.37 (492)	19.69 (500)
1,543 lb (700)	2,204 (1,000)	1,323 (600)
3.93 (100) - 24.01 (610)	3.93 (100) - 28.93 (735)	4.53 (115) - 24.61 (625)
1,417	1,654	1,260
CAT-40		
12,000		
15,000		
25 (18.5)		
29.5 (22)		
70.4 (95.5)		
81 (110)		
30 (50)		
30.00 (762)	41.34 (1,050)	45.07 (1,145)
16.14 (410)	20.08 (510)	
20.08 (510)	25.00 (635)	20.08 (510)
2.95 (75)		
5.91 (150)		
13.78 (350)		12.01 (305)
17.64 (8)		
2.2		
102.1 (2,593)	107.81 (2,738)	178.14 (4,525)
96.06 (2,440)	120.28 (3,055)	150.33 (3,818)
111.26 (2,826)	118.94 (3,021)	126.67 (3,217)
10,802 (4,900)	13,227 (6,000)	30,864 (14,000)

# Machine Specifications – VC-Ez

Capacity	Table Width	in (mm)
	Table Depth	in (mm)
Table Weight Capacity	Table Weight Capacity	lbs (kg)
Spindle Face to Table	Min - Max	in (mm)
Rapid Rates	Rapid Rates	ipm
Spindle	Spindle Taper	
	Maximum Speed	rpm
	Maximum Speed (Optional Spindle)	rpm
	Motor Output	hp (kw)
	Motor Output (Optional Spindle)	hp (kw) (10% ED)
	Torque	ft-lbs (N-m)
	Torque (Optional Spindle)	ft-lbs (N-m)
Magazine	Number of Tools	Standard (Optional)
Feed Axes	Travel (X Axis)	in (mm)
	Travel (Y Axis)	in (mm)
	Travel (Z Axis)	in (mm)
Maximum Tool Diameter	Without Adjacent Pockets Empty	in (mm)
	With Adjacent Pockets Empty	in (mm)
Maximum Tool Length		in (mm)
Maximum Tool Weight		lbs (kg)
Tool Change Time	Tool to Tool	sec
Dimensions	Machine Depth	in (mm)
	Machine Width	in (mm)
	Machine Height	in (mm)
	Machine Weight	lbs (kg)

VC-Ez 26	VC-Ez 32	VC-Ez 32 CAT 50
55.12 (1,400)	64.17 (1,630)	
24.02 (610)	28.35 (720)	
3,306 lb (1,500)	4,078.6 (1,850)	
3.93 (100) - 28.93 (735)	3.93 (100) - 34.05 (865)	3.93 (100) - 31.5 (800)
1,417	1,259	
CAT-40		CAT-50
12,000		6,000
15,000		6,000
25 (18.5) (5-minute rating)		29.5 (22) (30-minute rating)
29.5 (22)		--
70.4 (95.5)		665 (901) (low) 103 (139) (high)
81 (110)		--
30 (50)		24 (40)
50.00 (1,270)	64.17 (1,630)	
25.98 (660)	32.08 (815)	
25.00 (635)	30.12 (765)	27.56 (700)
2.95 (75)		4.13 (105)
5.91 (150)		8.27 (210)
13.78 (350)		
17.64 (8)		33.07 (15)
2.2		2.3
118.83 (3,018)	148.94 (3,783)	
132.08 (3,355)	157.48 (4,000)	
119.13 (3,026)	126.11 (3,203.3)	124.79 (3,169.7)
16,755 (7,600)	24,471 (11,100)	25,132 (11,400)

# Mazak MPower



To maximize machine tool investment, Mazak MPower provides the most-comprehensive support in the industry. MPower takes complete customer care to the next level, giving manufacturers the tools they need to achieve their business goals and ensure continued success.

## SINGLE-SOURCE SERVICE

MPower is a single point of contact for any Mazak-related service need, allowing customers to maintain the highest levels of productivity. MPower benefits include:

- Free technical phone support and software updates for the life of every Mazak machine
- Guaranteed phone response to any technical question within one hour through our 24/7 technical phone support system
- Services that include laser calibration to ISO, ANSI and JIS standards, ball bar qualification/analysis, vibration analysis/benchmarking, and preventive maintenance plans and programs
- More than 350 factory trained representatives and certified distributor personnel available within 24 hours under most circumstances for onsite service

## TECHNICAL SUPPORT – MACHINE AND CNC

Comprehensive two-year warranties on every Mazak machine tool include local support from a network of Technology and Technical Centers along with expert support through Mazak's Remote Assist Service that:

- Allows technicians to interact with connected devices to communicate and send work instructions to the customer
- Eliminates in-person diagnostic visits to avoid lengthy downtime
- Shortens repair time and reduces costs of in-person field service

## PARTS SUPPORT

Mazak's North American Parts Center provides 24/7 access to more than 500,000 unique part numbers in stock with:

- Average 97% same-day parts shipment and same-day shipping
- Next day deliveries
- Experienced call center part specialists available Monday-Saturday
- Digital connectivity via PartsWeb for pricing and online parts images
- Lifetime CNC parts support

## TRAINING

Take a self-paced course through our MPower On-Demand Learning (MODL) system, schedule an in-person class at one of our Technology or Technical Centers, or sign up for a customized seminar in your shop.

- Select subject matter from more than 100 multi-level courses
- Access essential courses anytime, anywhere
- Custom-tailor training programs, schedule classes to fit your schedules and adapt classes to suit your team's learning level

## SPINDLE AND UNIT REBUILD

Cost-effective Spindle Rebuilding Services are included under the MPower umbrella, raising the bar in efficiency and quality in OEM-factory-certified spindle rebuild services with:

- Support for 2,000 machine tool spindle models and a wide range of horsepowers and speeds
- More than 1,000 rebuilt spindles in stock ready for exchange
- Average three to five days spindle rebuild turnaround time

# Mazak Capital Equipment Financing (MCEF)

MCEF is a one-stop choice for manufacturers throughout the United States who want fast, hassle-free, low-cost financing on Mazak equipment. Our knowledge of Mazak's product portfolio results in factory terms that can work to your advantage. Plus, with our direct access to machine specifications, delivery schedules and installation dates, we work to reduce additional paperwork or delays in the approval or shipment process.

## MCEF benefits:

- Provides flexible, timely and competitive financing for companies of all sizes
- Offers a one-stop, seamless purchasing experience with direct access to delivery and installation schedules
- Obtains application approvals quickly (often within 24 hours)
- Creates customized financing programs to meet your specific requirements
- Preserves bank credit lines for working capital for your company's growth

## Mazak Capital Equipment Financing

6850 Industrial Road  
Florence, Kentucky 41042

Phone Number: (859) 342-1311

Toll-Free Number: (877) 634-5521

Fax Number: (859) 342-1502

Email: [financing@mazakcorp.com](mailto:financing@mazakcorp.com)

Send confidential files through our  
Secure File Transfer (SFT)



# Mazak

**MAZAK CORPORATION  
NORTH AMERICAN MANUFACTURING  
HEADQUARTERS**

8025 Production Drive, Florence, KY 41042  
Tel: (859) 342-1700 Fax: (859) 342-1865

[www.MazakUSA.com](http://www.MazakUSA.com)

- Specifications are subject to change without notice.
- This product is subject to all applicable export control laws and regulations.
- The accuracy data and other data presented in this catalogue were obtained under specific conditions. They may not be duplicated under different conditions (room temperature, workpiece materials, tool material, cutting conditions, etc.)
- Unauthorized copying of this catalogue is prohibited.

